

Surface Mount LED J Series for low current or superbright use, 0678 Bicolor Series

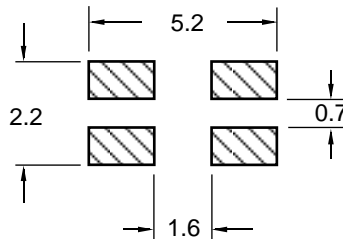

The 0678 series lamps are miniature chip type designed for surface mounting. These lamps are the so-called "Top LED" type, measuring approximately 2.8 x 3.6 mm. These lamps are in EIA481 tape and reel packaging with approximately 2000 pcs per reel.

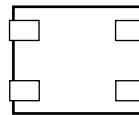
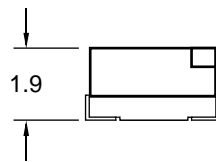
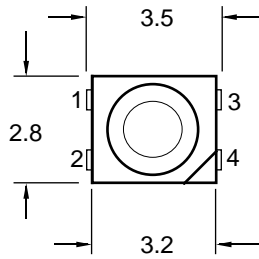

Recommended
reflow
solder pattern

Pin assignments:

- Bi-color: 1. Green cathode
2. Red anode
3. Green anode
4. Red cathode

- Full color: 1. Red cathode
2. Common Anode
3. Blue cathode
4. Green cathode



RoHS Compliant
Aug 2004

GENERAL INFORMATION

Operating Temperature Range	-40 °C to +85 °C
Storage Temperature Range	-40 °C to +90 °C
Reflow Soldering Temperature	260 °C for 5 sec max

APPLICATION INFORMATION (ALL RATINGS AT 25 °C AMBIENT)

Part No.	Emitted Color	Peak	$\Delta\lambda$	Absolute Maximum Ratings					E/O Characteristics					
		λ		Pd	If (mA)		Ir	Vr	Iv (mcd) @ If=20mA			Vf (V) @ If=20mA		$2\Theta_{1/2}$ (Deg)
		(nm)			(mW)	dc			1/10 duty @ 1 kHz	@ Vr=5V (μ A)	(V)	2mA	Min	
JRGC0678	Red	632	20	60	25	160	10	5	4	25	61	2.0	2.4	120
	Green	575	20	60	25	160	10	5	1	17	25	2.0	2.4	120
JEGC0678	OrRed	639	20	60	25	160	10	5	3	23	49	2.0	2.4	120
	Green	575	20	60	25	160	10	5	1	17	25	2.0	2.4	120
JRGB0678	Red	632	20	60	25	160	10	5	3	20	47	2.0	2.4	120
	Green	575	20	60	25	160	10	5	1	13	20	2.0	2.4	120
	Blue	428	65	140	30	70	50	5	1	11	18	3.8	4.5	120

Specifications subject to change without notice. Dimensions are in mm \pm 0.3 unless stated otherwise.

IDEA, Inc., 1351 Titan Way, Brea, CA 92821 Ph:714-525-3302, 800-LED-IDEA; Fax: 714-525-3304 0508

013S-J067m